

# O.C.-PLAN®

## THE WATERPROOFING MEMBRANE MADE OF ECB

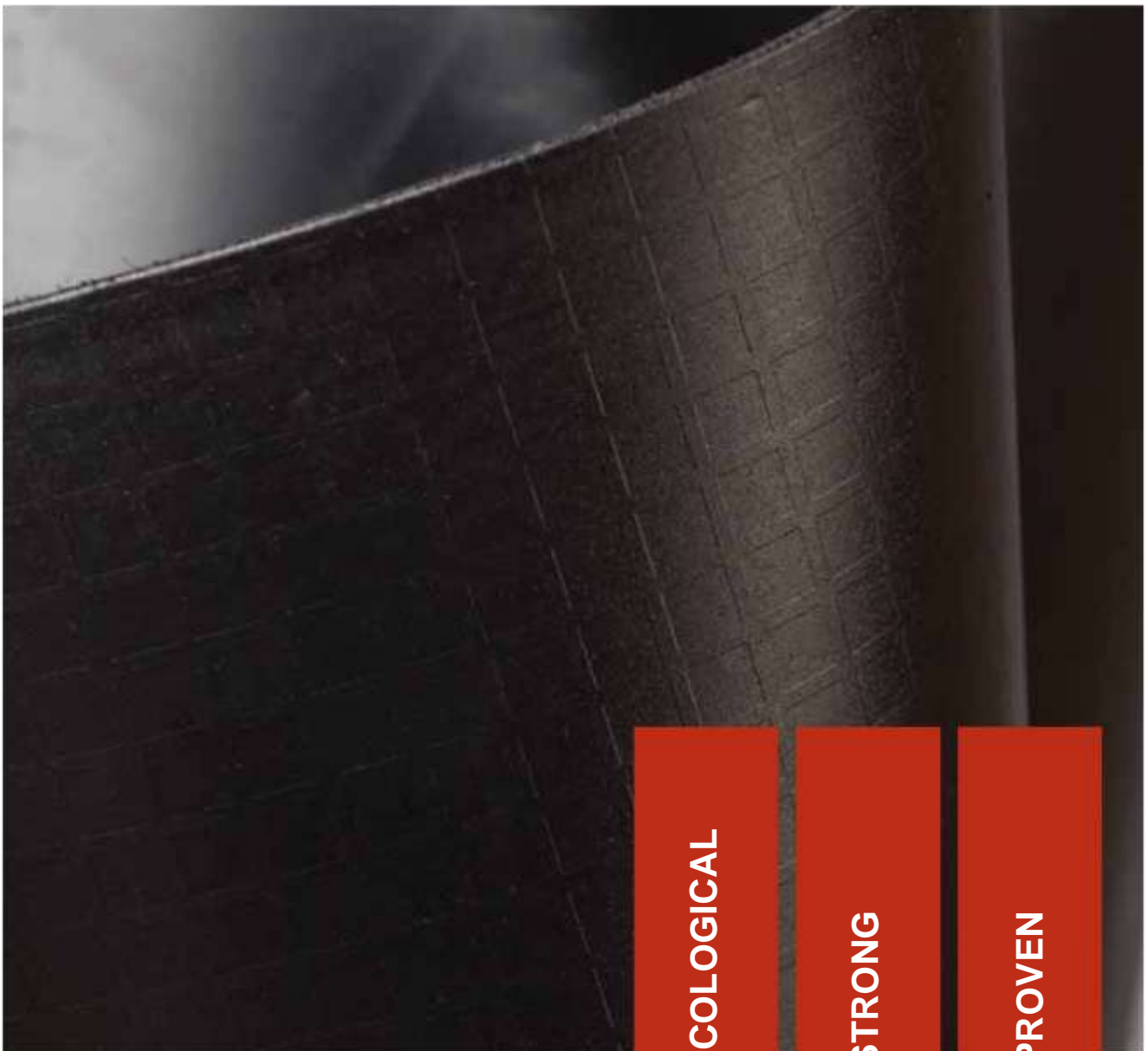

ECOLOGICAL

STRONG

PROVEN



**POLYFIN AG**

Flat Roof Technology for the Future

---

# O.C.-PLAN® - THE WATERPROOFING MEMBRANE MADE OF ECB

---

O.C.-Plan® is a high quality synthetic single ply membrane, consisting of ECB (Ethylene Copolymer Bitumen), which is also, from an ecological perspective, on environmentally sound and superbly practical and easy to handle in installation.

The O.C.-Plan® is an extremely environmentally friendly material and is also easy to install. O.C.-Plan® is a product manufactured to the highest standards of quality. Additionally, O.C.-Plan® is compatible with bituminous roofing and polystyrene insulation, which makes it ideal for both new construction and refurbishment projects.

O.C.-Plan® is suitable for all types of flat roof construction and can be installed by various methods such as mechanical fixing or adhesive bonding. Furthermore it can be used in other structural waterproofing applications such as foundations, cellars and basements and underground car parks.

In today's market, environmental considerations and sustainability are becoming increasingly important making O.C.-Plan® the ideal choice.

If you require an ecologically acceptable product, O.C.-Plan® will give you everything you require as proved by our Environmental Product Declarations (EPD) made in accordance with ISO 14025 and EN 15804 published by Institut für Bauen und Umwelt e.V (IBU - Institute for Construction and Environment).

---

## THE ADVANTAGES OF O.C.-PLAN® PUT YOU IN THE FOREFRONT OF MODERN TECHNOLOGY

### Ecological

O.C.-Plan® is environmentally friendly as it contains no products that are harmful to the atmosphere, such as, plasticizers, halogens and chlorides (such as are found in PVC membranes). In addition the hot air welding of the seams produces no toxic or dangerous substances. The welds do not require pre-treatment with solvent.

In addition O.C.-Plan® is ideal for green roofs as without additional layers or additives, it is root and rhizome resistant in accordance with tests carried out under FLL requirements.

### Strong

Due to its high quality O.C.-Plan® enjoys long-term stability as it is tough and resistant to mechanical damage including severe temperature fluctuations and weather conditions such as hailstones.

### Proven

The proof and reliability of O.C.-Plan® is that it has been in use for over 40 years. Millions of square meters have been laid during this period and are still existing, demonstrating the safety and longevity of O.C.-Plan®. Quality assurance is carried out according to ISO 9001:2000 (TUV Certification) and CE Certification in accordance with DIN EN 13956 and DIN EN 13967.

---

COMPATIBLE TO BITUMEN AND POLYSTYRENE • ROOT- AND RHIZOME RESISTANT  
TO FLL-PROCESS • TESTED FIRE PROTECTION • SIMPLE INSTALLATION AND  
PROCESSING • SECURE SEAM WELDING TECHNOLOGY • LARGE WELDING  
TEMPERATURE WINDOW

---

# LET THE NUMEROUS APPLICATIONS OF O.C.-PLAN® CONVINCING YOU

ECONOMIC SOLUTIONS FOR EVERY ROOF CONSTRUCTION

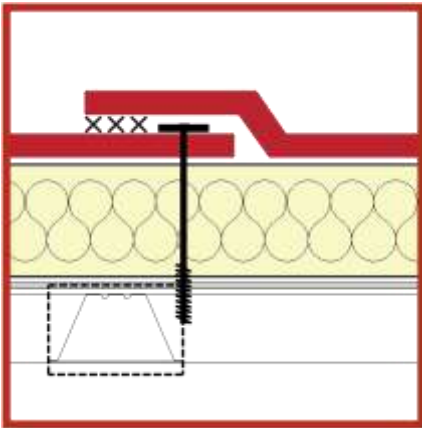

MECHANICALLY FASTENED

O.C.-Plan® 3020  
O.C.-Plan® 4230

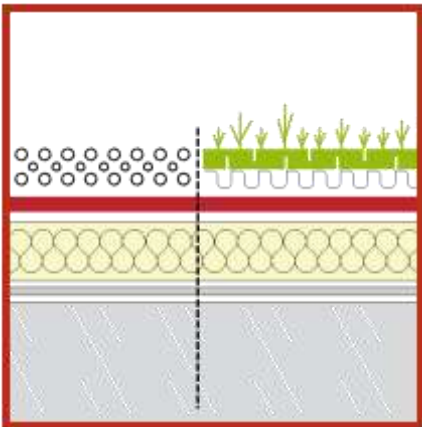

LOOSE LAID WITH BALLAST

O.C.-Plan® 3020  
O.C.-Plan® 4125  
O.C.-Plan® 4230

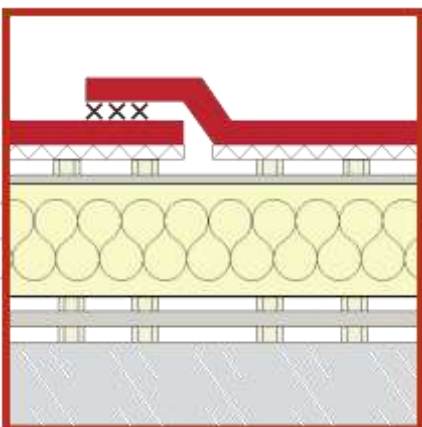

BONDED APPLICATION

O.C.-Plan® 4230 (strip bonded or fully bonded)  
O.C.-Plan® 4125 (strip bonded or fully bonded)  
O.C.-Plan® 5028 SK (fully self-adhesive bonded)

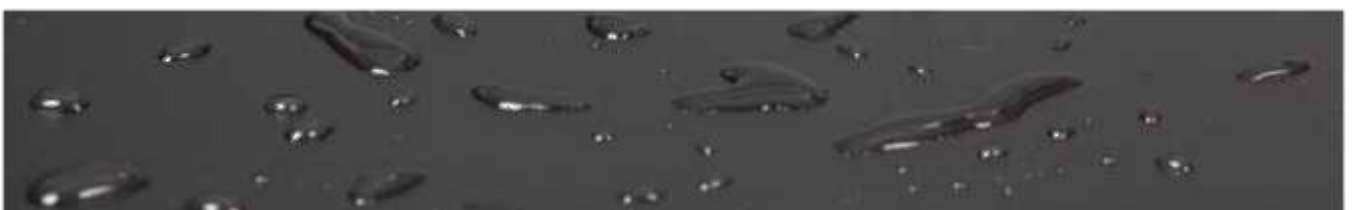

---

## SAVE TIME - MORE EFFICIENT EVERYDAY WORK WITH O.C.-PLAN® SK

In addition to our standard range of O.C.-Plan® products, we also have O.C.-Plan® SK waterproofing membrane, which is self-adhesive on the underside. O.C.-Plan® SK allows you to proceed faster with the installation because:

- a) The membrane can easily be rolled out and aligned.
- b) Laying and bonding takes place in one single operation.
- c) A separate adhesive application is not required so there is no time lost waiting for adhesives to dry.
- d) It can be used on steep or vertical surfaces.

You can rely on O.C.-Plan® SK! O.C.-Plan® SK comes with an adhesive free salvage edge, which facilitates a homogenous hot air seam weld. O.C.-Plan® SK is user friendly, adaptable and easy to install. O.C.-Plan® SK is also ideal for installing flashings. Vertical flashings up to 50 cm high can be installed without the use of time consuming mechanical fixings.

---

Save up to  
50% working

There are three simple stages in the installation:

- 1) Roll out and align the membrane.
  - 2) Remove the peel off backing foil and apply pressure to adhere the membrane to the substrate.
  - 3) Roll out the adjacent sheet, align it and carry out the hot air seam welding.
- 

### APPLICATION EXAMPLES

#### WALL FLASHING

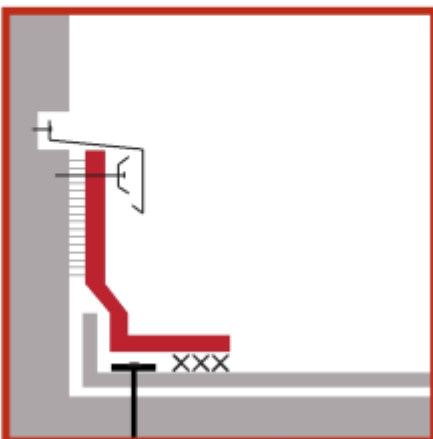

#### FLASHING TO ROOF LIGHT

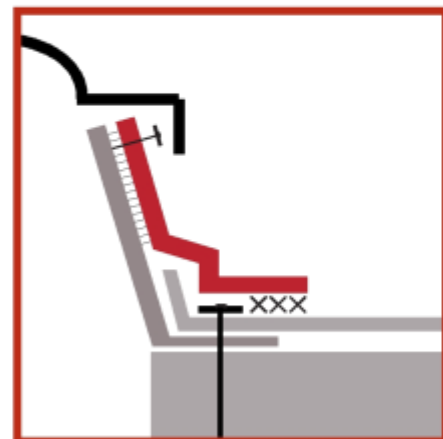

LUSANUM LUDWIGSHAFEN



ADIDAS HERZOGENAURACH



LU-TECO LUDWIGSHAFEN



EDEKA HAMM



LIDL HÜFINGEN



Technical data	O.C.-Plan® 3020 black, glass fleece reinforced	O.C.-Plan® 4230 black, glass fleece reinforced and bottom sided fleece backed, fleece free welding edge on one side	O.C.-Plan® 4125 black, glass fleece reinforced and bottom sided fleece backed, fleece free welding edge on one side	O.C.-Plan® 5028 SK black, glass fleece reinforced, bottom sided self-adhesive coating, welding edge without coating on both sides
Loose laid with ballast incl. green roof	•	•	•	-
Loose laid and mechanically fixed	•	•	•	-
Strip bonded (partially)	-	•	-	-
Fully bonded	-	•	•	-
Fully self-adhesive bonded	-	-	-	•
Total thickness in mm	2.0	3.0	2.5	2.8
Width in mm	2100 / 1500 / 1050 / 750 / 525 / 350 / 250	2100 / 1050 / 525	1050	1050
Length per roll in m	20	20	20	15

